

# Residential & Light Commercial Cast Iron Hot Water Sealed Combustion Gas Boilers: GA244

High Efficiencies: AFUE of 85 %  
GL180M Cast Iron Heat Exchanger  
Induced Draft Design  
4 Inputs: 156,000 to 262,000 Btu/hr



# Buderus

## GA244 Sealed Combustion Series

# GA244 Series Gas Fired Sealed Combustion Boilers set new standards for efficiency, quality and comfort. Tight mechanical rooms, no combustion air, no problem!

## Versatility:

- Two venting configurations: Horizontal with concentric single wall penetration terminal.  
Vertical with special "through the roof" system.
- Four venting systems: Approved for use with Heat Fab, Z-Flex, Flex-L and Pro-Tech 3" AL 29-4C stainless steel material (4" for /53 and /62 Model).

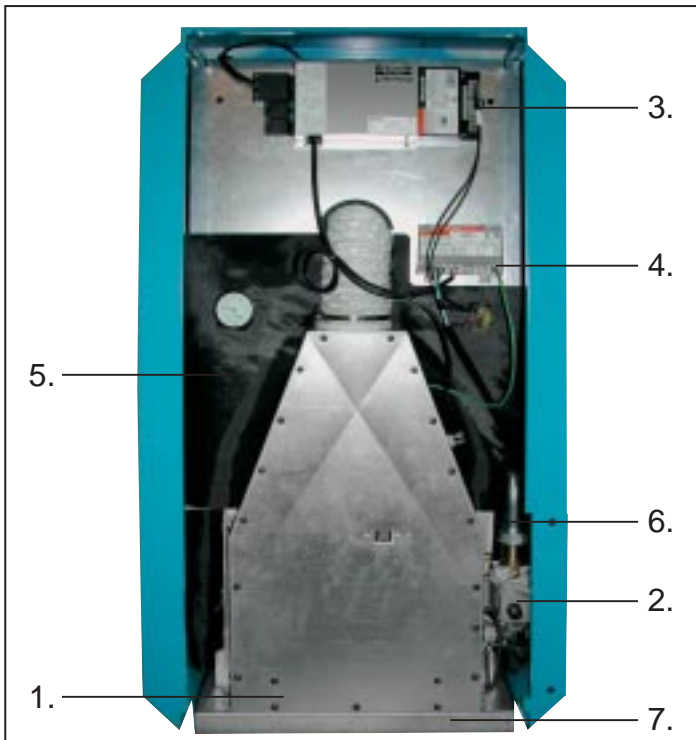

1. Sealed burner box with stainless steel burners.
2. Gas valve with intermittent ignition.
3. Honeywell aquastat and quick electrical connections.
4. Honeywell ignition module.
5. 3-1/2" Thermal wrap-around insulation.
6. Access cover for gas valve.
7. Non-combustible boiler base.

## Efficiency By Design:

- Boiler AFUE ratings up to 85 % for top performance.
- Stainless steel premixed factory tested burners for low emissions.
- Available in Natural Gas and Propane options.
- Durable, quiet and efficient, designed for long life.
- Full 3 inches thermal insulation for minimal standby loss.

## Quality Features

- Manufactured by Buderus, world's leader in cast iron boiler design and production.
- Flexible GL-180M cast iron, designed to resist thermal shock for long life.
- High silicone cast iron surface for excellent corrosion resistance.
- Staggered, contoured fins for optimum heat transfer and efficient operation.
- Deluxe, heavy gauge blue enameled jacket.
- Whisper quiet operation with integrated draft inducer.
- Attractive design with front accessible controls, all piping connections in the rear for finished appearance.



C.S.A. Certified for  
Natural and  
Propane Gas



Tested for 58 lbs.  
ASME Working  
Pressure



C.S.A. Certified for  
Natural and  
Propane Gas



## Service Features:

- Approved for closet installations.
- Approved for installation on combustible floor with non-combustible base.
- Quick electrical disconnects for easy wiring.
- Simple wiring for easy trouble shooting.
- Universal terminal body for use with any venting system.
- All rear tappings for easy and clean installation.
- Burner tray easily removed for service and LP field conversion.
- Simple packaged design for easy and fast installation.

## Possible System Upgrades

### Indirect fired hot water storage tanks

- Vertical models with improved recovery rates.
- Easy access port for cleaning of tank interior.
- “Duoclean” interior tank protective coating assures corrosion resistance for long resistance for long life and ease of cleaning.
- Well insulated tank loses less than  $\frac{1}{4}$  °F per hour.
- Large diameter coiled heat exchanger for excellent recovery rates.
- Heat exchanger size increases with tank volume.
- Extra thick Magnesium anode rod for active corrosion protection.
- Standard electric anode on ST tank models.



Buderus ST Tank

### Buderus Logamatic control systems

- Low temperature boiler operation for superior comfort and improved fuel efficiency.
- Complete space heating control based on outside temperature with room temperature compensation.
- Priority heating of domestic hot water.
- Adjustable night setback for additional efficiency.
- Adjustable factory heating programs allow customized operation.
- Built-in self diagnostics for ease of service.



Logamatic Control

# Dimensions and Technical Data for GA244 Gas Boilers

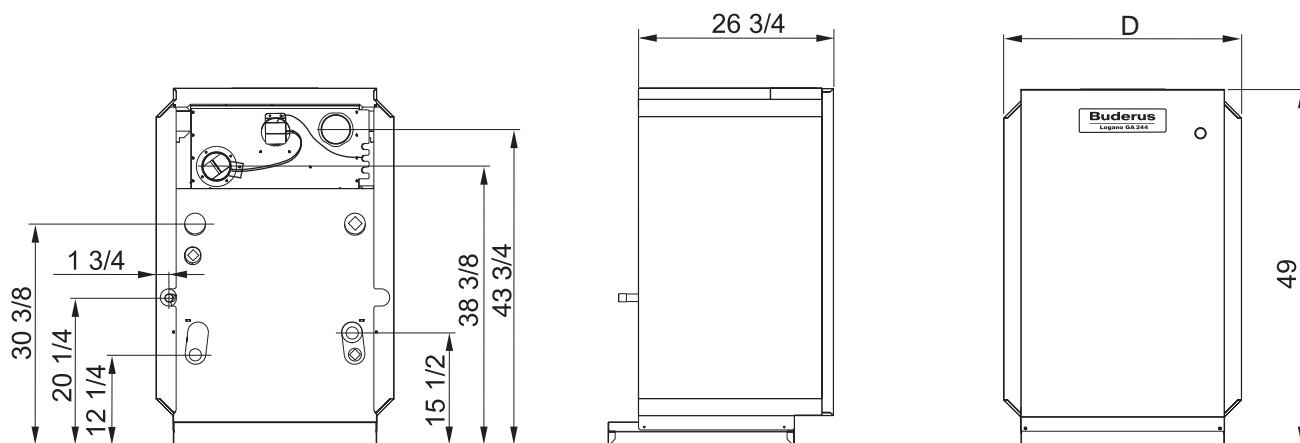

GA244 Series		GA244/37	GA244/44	GA244/53**	GA244/62**
Input	Btu/hr	156,000	182,000	220,000	262,000
Heating Capacity	Btu/hr	128,000	148,000	App. 181,000	App. 212,000
NET IBR Rating*	Btu/hr	111,000	129,000	156,000	181,000
AFUE	%	85	85	N/A	N/A
Vent Size	Inch	3	3	3 or 4	4
Air Intake Size	Inch	4	4	4	4
Dry Weight	Lbs	635	635	712	834
Gas Connection	Inch	3/4	3/4	3/4	3/4
Water Content	Gal	6.1	6.1	7.1	8.2
Number of Burners		4	4	5	6
Flow Resistance at 20 FΔT	ft. of head	1.3	1.8	2.1	2.4

\* The NET IBR ratings are based on a piping allowance of 1.15. consult factory before selecting a boiler for installations having unusual piping and pick-up requirements such as exposed piping.  
 \*\* GA244/53 and /62 models available early 2004.

## Venting Requirements:

**Intake:** Use 4" galvanized or flexible pipe (30' for vertical system).

**Exhaust:** Use 3" approved AL29-4C stainless steel venting material (Heat-Fab, Flex-L, Pro-Tech, Z-Flex).  
 Use condensate drain as starting piece at 3" boiler exhaust connection.  
 One 90° elbow is equivalent to 10', 2 45° elbows equivalent to 10' of vent pipe.  
 Maintain minimum 1" clearance to combustibles for vent pipe in unenclosed spaces (Flex-L, Z-Flex).  
 Slope exhaust system upward from the boiler 1/4" per foot.  
 Use high temperature silicone (GE 106 or equivalent) for sealing of vent component.  
 Refer to Table for maximum permissible vent length.

Model	Horizontal System	Vertical System
GA244/37	50'	40'
GA244/44	40'	40'
GA244/53	40'	40'
GA244/62	40'	40'

# Buderus

## HYDRONIC SYSTEMS

Buderus Hydronic Systems, Inc.  
 50 Wentworth Ave • Londonderry, NH 03053  
 Tel: (603) 421-2760 • Fax: (603) 421-2719